

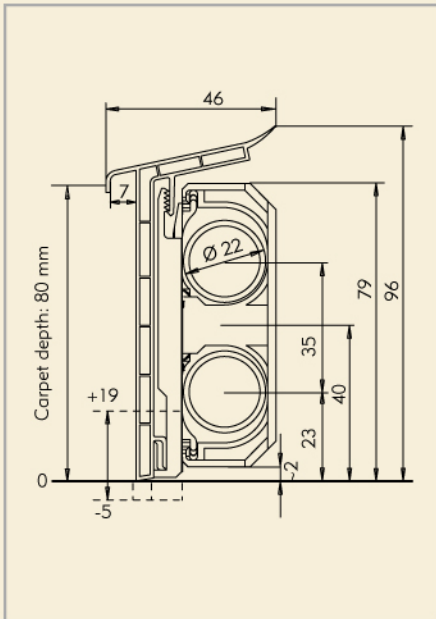

SLT 2000

The profile with self-adhesive tape for laying carpets, for pipes up to 22 mm in two finishes

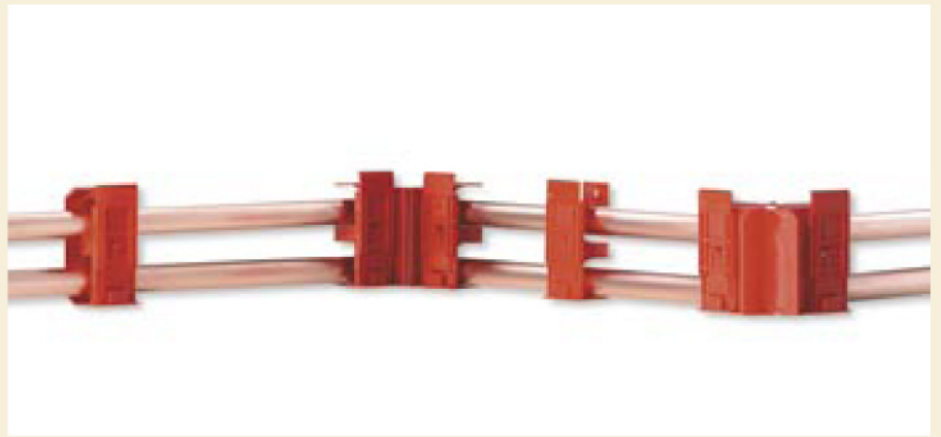

Dimensions of SLT 2000 profile, here with bracket 2250

The SLT 2000 profile is used when you want the carpet to determine the appearance of the skirting board. The profile has self-adhesive tape so that the carpet can be laid.

It is a robust plastic hollow space profile with a sealing lip on the wall to compensate for uneven surfaces. The outstanding feature of the profile's extremely durable material is its high impact resistance. Matching dummy skirting boards (see page 18) are also available.



The self-adhesive tape is only suitable for carpets with a smooth foam coating. With other carpeting additional contact adhesive or additional double-sided adhesive tape is necessary.

The profile is attached similarly to the SLF 2000 profile with the bracket art. no. 2150 after laying pipes, or with the bracket art. no. 2250 before laying pipes, in which case bracket art. no. 2250 is also particularly well suited for uneven walls.



We recommend spacing the brackets every 50 cm. If there are problems with the walls, space the brackets more closely together.

The brackets are attached with nail plug art. no. 208.

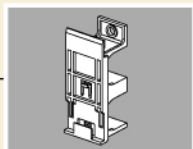

HZ bracket art. no. 2150 (SCH 2150)

Bracket for mounting over pipes after they have been laid, up to 22 mm. Fits all HZ SLF 2000, HZ SLT 2000 and HZ SLL 2000 profiles. Packing unit: 40 pcs Number required: 2 per metre. To ensure that mounting is not under any strain, we recommend positioning the bracket 1-3 mm from the floor.

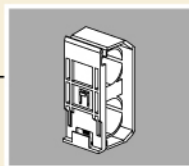

HZ bracket art. no. 2250 (SCH 2250)

Bracket for mounting under pipes prior to laying, up to 22 mm. Fits all HZ SLF 2000, HZ SLT 2000 and HZ SLL 2000 profiles. Packing unit: 40 pcs Number required: 2 per metre To ensure that mounting is not under any strain, we recommend positioning the bracket 1-3 mm from the floor.

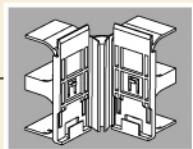

HZ bracket art. no. 2151 (SCH 2151)

Bracket for mounting over pipes after they have been laid, up to 22 mm, for press-fit systems up to 18 mm. Only for use with IE 2000, IET 2000 and IEL 2000 in matching finish. Packing unit: 40 pcs Number required: 1 per inner corner

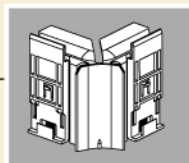

HZ bracket art. no. 2152 (SCH 2152)

Bracket for mounting over pipes after they have been laid, up to 22 mm, for press-fit systems up to 18 mm. Only for use with AE 2000, AET 2000 and AEL 2000 in matching finish. Packing unit: 40 pcs Number required: 1 per outer corner



Nail plug art. no. 208 (ND 80-8)

Wall plug with countersunk head and threaded nail. Packing unit: 50 pcs. Requirements: 1 per bracket, 2 per corner bracket Please use article 204 to provide additional mounting for bracket 2150!



Screw plug art. no. 209 (DHB 80-8)

Screw plug for hollow block & Rigips (plasterboard) walls Packing unit: 50 pcs Number required: 1 per bracket, 2 per corner bracket Note: Torx contour



Light oak
2260

White (≈RAL 9010)
2280

With the corners of the SLT 2000 profile you can also choose between the HZ 2000 corners and the corners for custom solutions.

When using the HZ 2000 inner corner you need an inner corner bracket (art. no. 2151), when using the HZ 2000 outer corner an outer corner bracket is needed (art. no. 2152). When cutting the skirting board profile to size, remember that for each inner corner bracket used the profile has to be shortened by 45 mm.

The corner brackets provide firm support for the profile and the corner moulded parts. When using the corner brackets no mitre cut is required. This saves valuable time in installation.

The inner and outer corners for custom solutions are used when more space is needed in the corners. This may be the case with press-fit systems. The corners are then pressed sideways onto the skirting boards which have a mitre cut. You will find assistance in choosing the right corner solution on pages 16 and 17.

The profile is pressed against the wall and pushed down into the brackets. The inner and outer corners are slid over the square-cut skirting boards onto the corner brackets.

Combined with the HZ radiator connections you will be able to obtain a perfect appearance.

In the case of walls which are very uneven we recommend using an additional sealing lip that is stuck on. You can find these on page 20.

Carpet skirting boards

Skirting boards for carpet insert with self-adhesive tape
Packing unit: 40 m
Length: 4 m

Inner corner

IMPORTANT:
Only for use in combination with IE SCH 2151
Packing unit: 10 pcs

Outer corner

IMPORTANT:
Only for use in combination with AE SCH 2152
Packing unit: 10 pcs

Butt joint

Packing unit: 10 pcs

Left end piece

Packing unit: 10 pcs

Right end piece

Packing unit: 10 pcs

Inner corner for custom solutions

For working without inner corner brackets,
Packing unit: 10

Outer corner for custom solutions

For working without outer corner brackets,
Packing unit: 10

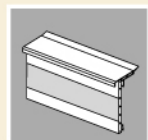

Light oak
Art. no. 2260
(SLT 2000 EH)

White
Art. no. 2280
(SLT 2000 W)



Light oak
Art. no. 2261
(IET 2000 EH)

White
Art. no. 2281
(IET 2000 W)



Light oak
Art. no. 2262
(AET 2000 EH)

White
Art. no. 2282
(AET 2000 W)



Light oak
Art. no. 263
(STT EH)

White
Art. no. 283
(STT W)

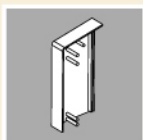

Light oak
Art. no. 264
(EST EH left)

White
Art. no. 284
(EST W left)



Light oak
Art. no. 265
(EST EH right)

White
Art. no. 285
(EST W right)



Light oak
Art. no. 261
(IET EH)

White
Art. no. 281
(IET W)



Light oak
Art. no. 262
(AET EH)

White
Art. no. 282
(AET W)